

Original BMW Accessories. Installation Instructions.



Portable Navigation Retrofit BMW 3 Series (E90, E91, E92, E93)

These installation instructions only apply to cars without an on-board monitor.

Retrofit kit no. 65 90 430 516 Portable navigation retrofit kit

Installation time

The installation time is **approx. 0.75 hours**. This may vary depending on the condition of the car and the equipment in it.

Important information

These installation instructions are primarily designed for use within the BMW dealership organisation and by authorised BMW service companies.

In any event, the target group for these installation instructions is specialist personnel trained on BMW cars with the appropriate specialist knowledge.

All work must be completed using the latest BMW repair manuals, circuit diagrams, servicing manuals and work instructions in a rational order using the prescribed tools (special tools) and observing current health and safety regulations.

If you experience installation or function problems, limit troubleshooting to approx. 0.5 hours for mechanical or 1.0 hour for electrical work.

In order to reduce costs and avoid any additional expense, send a query immediately to the Technical Parts Support via the Aftersales Assistance Portal (ASAP).

Specify the following information:

- Chassis number
- Part number of the retrofit kit
- A precise description of the problem
- Work steps already carried out

Do not archive the hard copy of these installation instructions since daily updates are made by ASAP!

Pictograms



Denotes instructions that draw your attention to special features.

- ◀ Denotes the end of the instruction or other text.

Installation information

All pictures show LHD cars; proceed accordingly on RHD cars.

Ensure that the cables and/or lines are not kinked or damaged as you install them in the car. The costs thereby incurred will not be reimbursed by BMW AG.

Additional cables/lines that you install must be secured with cable ties.

If the specified PIN chambers are occupied, bridges, double crimps or twin-lead terminals must be used.

Special tools required

00 9 340 Removal tool (2x)

Table of contents

1. Parts list 3

2. Preparatory work 4

3. Connection diagram 5

4. To install the Portable navigation system 6

5. Concluding work and coding 8

1. Parts list

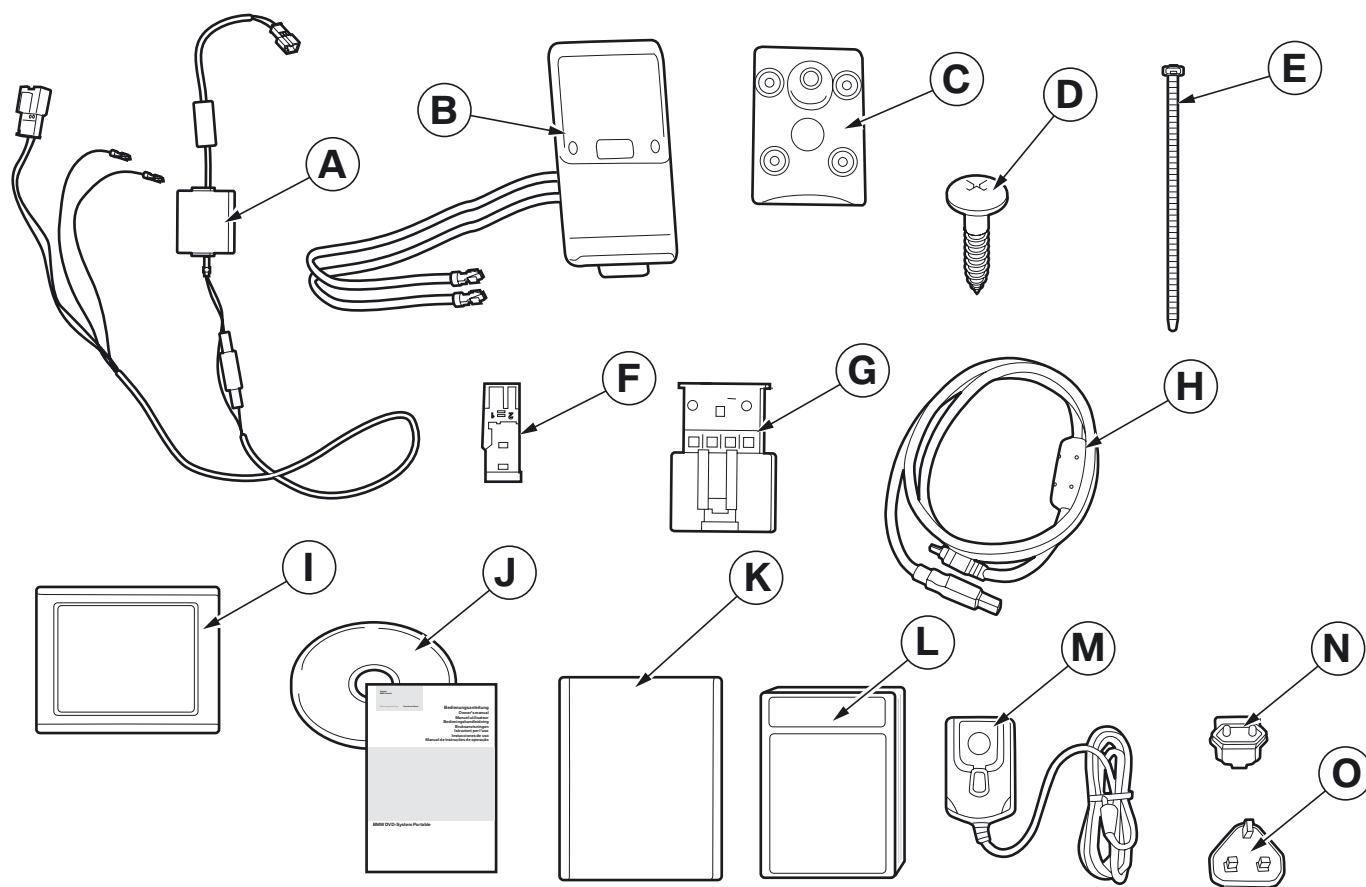

091 0193 Z

Legend

- A** Wiring harness
- B** Navigation device holder
- C** Base plate
- D** Philips screw (4x)
- E** Cable tie (5x)
- F** GN 2-pin socket casing
- G** SW 4-pin socket casing
- H** USB cable
- I** Navigation device
- J** Owner's manual, quick guide, security code, information
- K** Cover for navigation device holder
- L** Pocket for navigation unit
- M** Charging cable
- N** Adapter EU (not for US)
- O** Adapter UK (not for US)

2. Preparatory work

	TIS no.
Conduct a brief test	---
Disconnect negative pole of battery	12 00 ...
The following components must be removed first of all	
Pedal trim	51 45 185

3. Connection diagram

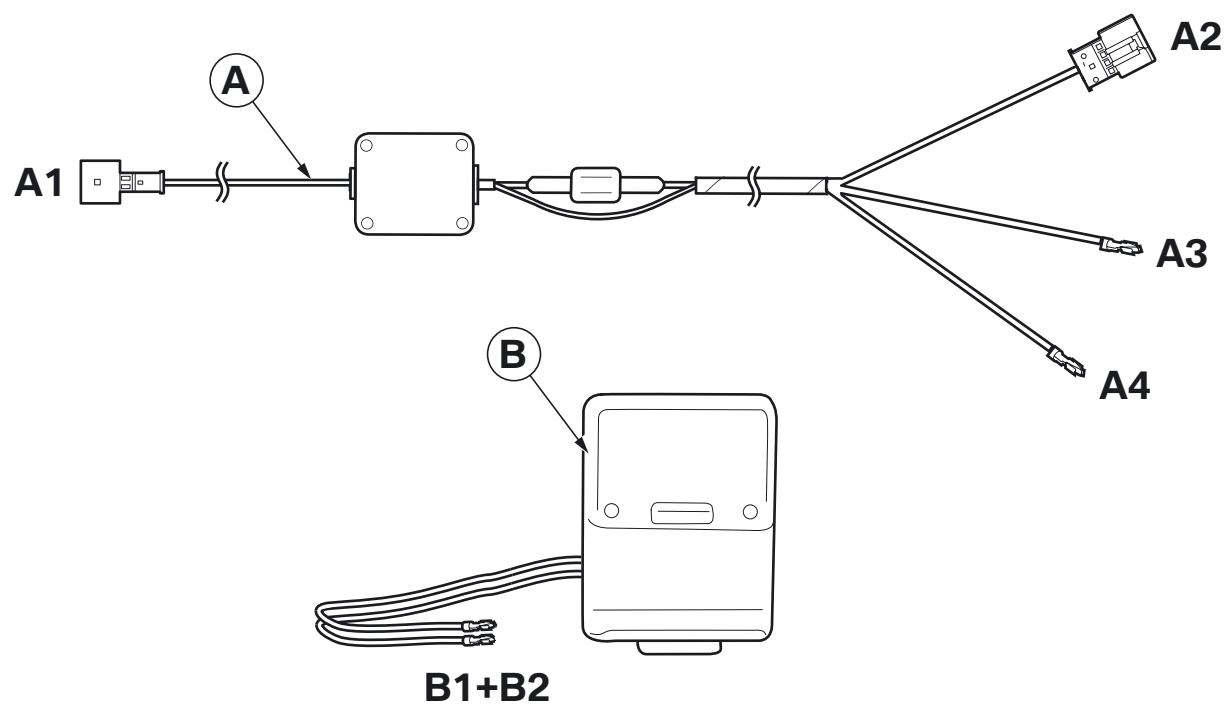

091 0194 Z

Branch / Item	Designation	Signal	Cable colour / Cross-section	Connection site in the car	Abbreviation / Slot
A	Wiring harness	---	---	---	---
A1	GN 2-pin plug casing	---	---	On socket casing F	---
A2	SW 4-pin plug casing	---	---	Not required	---
A3	Socket contact	Terminal 31	SW 0.5 mm ²	On the CAS, with miniature connector to BR cable	X13376 PIN 25
A4	Socket contact	Terminal 15	RT 0.5 mm ²	On the CAS, with miniature connector to GN cable	X13376 PIN 8
B	Navigation device holder	---	---	---	---
B1	Socket contact	Terminal 31	SW 0.5 mm ²	With socket casing F on branch A1	PIN 2
B2	Socket contact	Terminal 15	RT 0.5 mm ²	With socket casing F on branch A1	PIN 1

4. To install the Portable navigation system

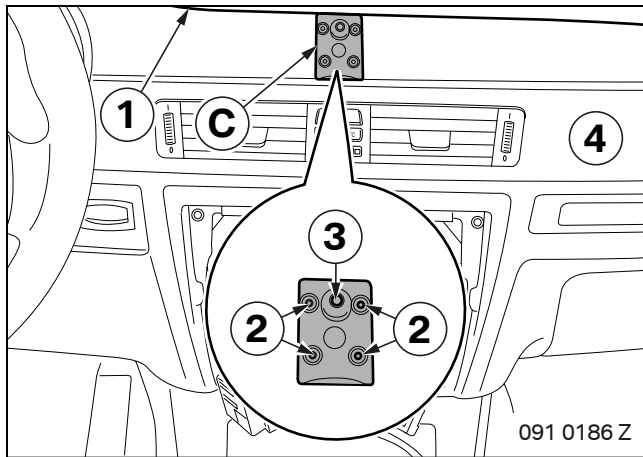

Hold base plate **C** centrally over the hazard lights switch and flush with the top edge (1).

Mark the mounting points (2) and hole for the cable penetration (3).

Remove the décor strip (4)
(see TIS RA no. 51 45 380).

Drill the holes (2) using a 3 mm twist drill bit and the hole (3) using a 6 mm twist drill bit.

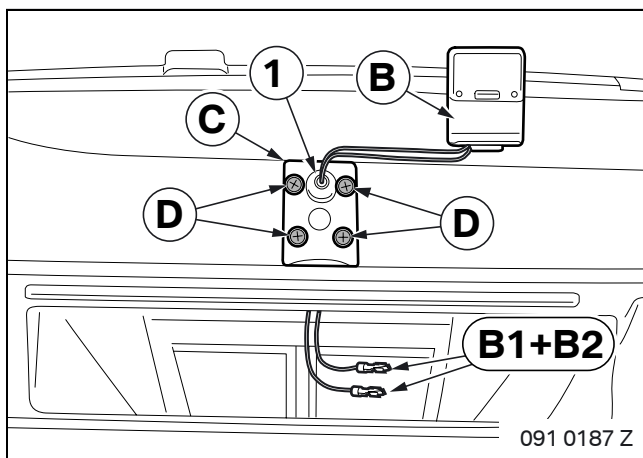

Secure base plate **C** using Philips screws **D**.

Route branches **B1** and **B2** through the joint (1).

Clip navigation device holder **B** onto base plate **C**.

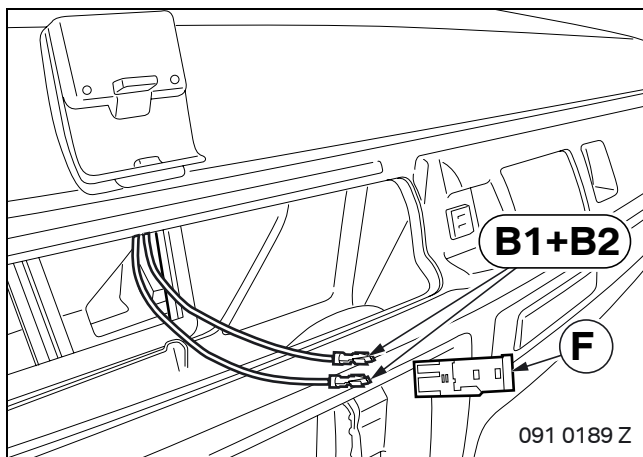

Connect branches **B1** and **B2** to socket casing **F** (GN 2-pin), as follows:

- Branch **B1**, SW cable, to PIN 2
- Branch **B2**, RT cable, to PIN 1

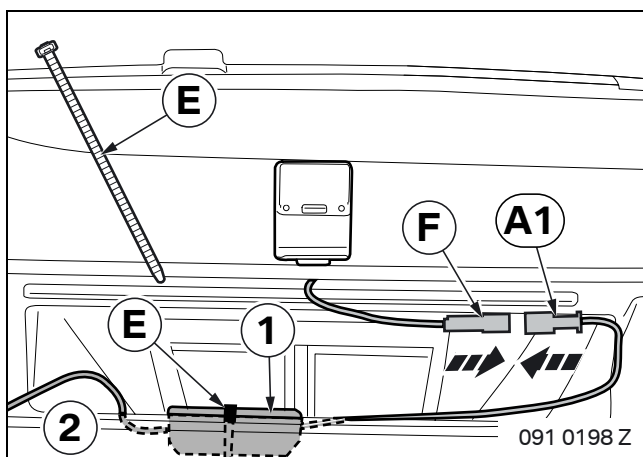

Connect socket casing **F** to branch **A1**.

Use cable tie **E** to attach the voltage converter (1) to the heating box (2).

Secure cable set with cable ties **E** to the standard wiring harness.

4. To install the Portable navigation system

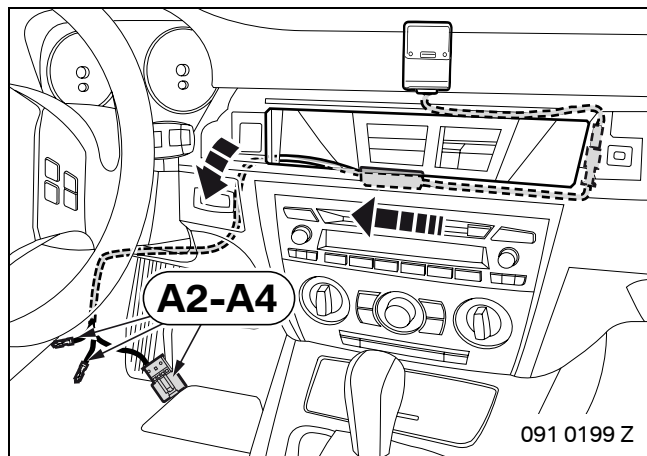

Route branches **A2-A4** to the CAS control module.

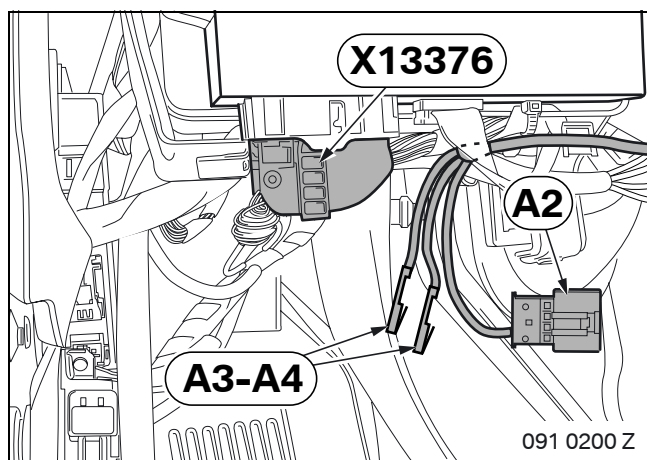

Separate socket contacts from branches **A3** and **A4** and connect with a miniature connector to plug **X13376** (41 pin SW):

- Branch **A3**, black cable, to PIN 25 (cable colour BR)
- Branch **A4**, RT cable, to PIN 8 (cable colour GN)

Tie back plug casing **A2**.

5. Concluding work and coding

The retrofit system does not require coding.

- Conduct a brief test
 - Conduct a function test
 - Re-fit the car components as required
-  Give all remaining items in the retrofit kit to the customer. ◀